



Manuale d'installazione
Installation Manual

WELLNESS
SERIES
Inox



**Colonna doccia esterna
da parete completa**
(Doccetta tonda, Soffione tondo)
Exposed shower group
(round Head Shower, round Hand Shower)

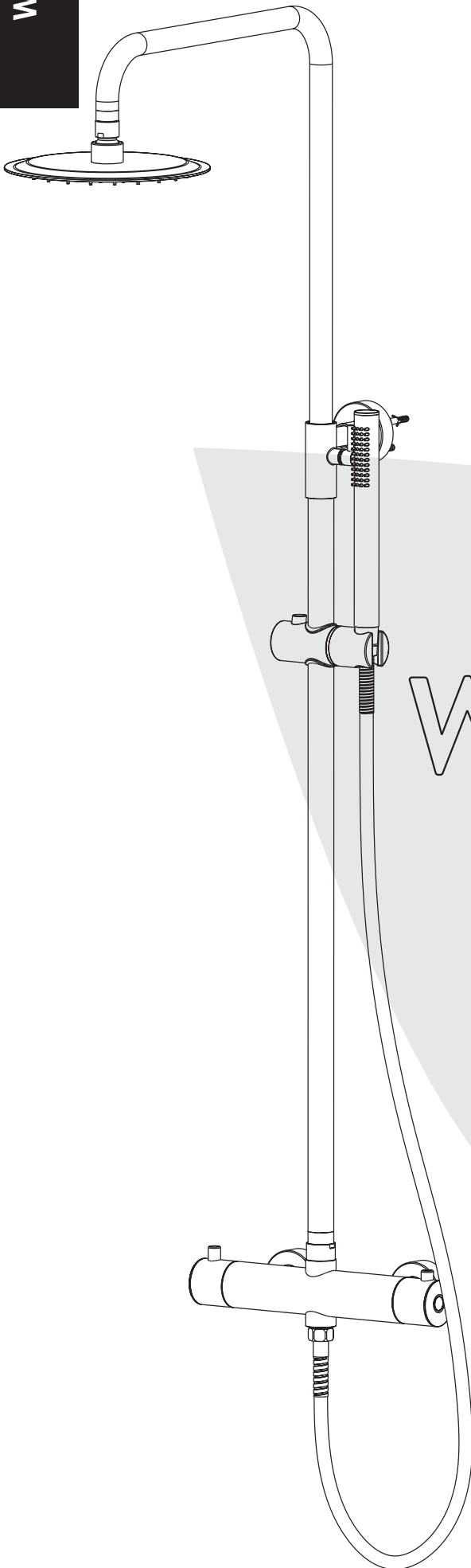



Indice

Index

Dimensioni <i>Dimensions</i>	pag. 3
Ricambi <i>Spare parts</i>	pag. 4
Installazione <i>Installation</i>	pag. 5/7
Portate <i>Flows</i>	pag. 8/9
Manutenzione Generale <i>General Maintenance</i>	pag. 10

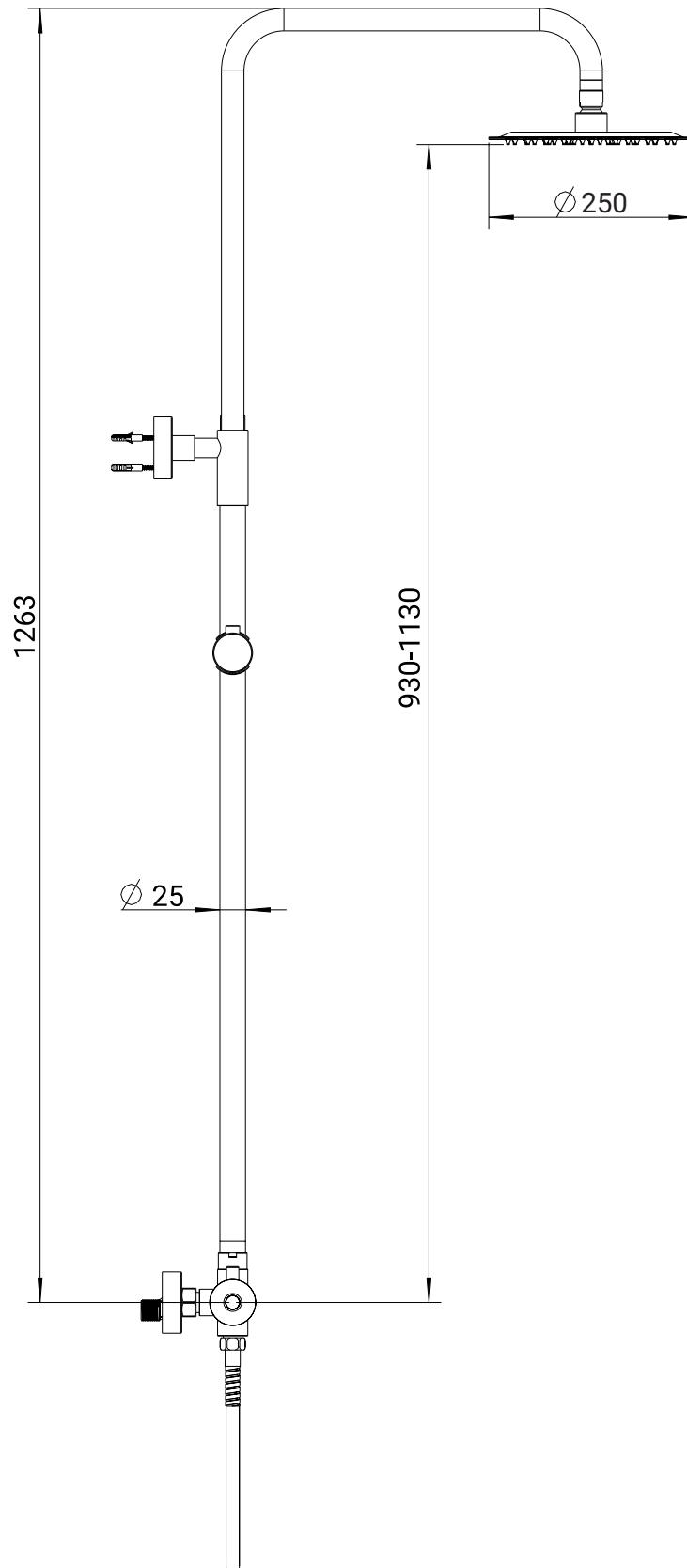

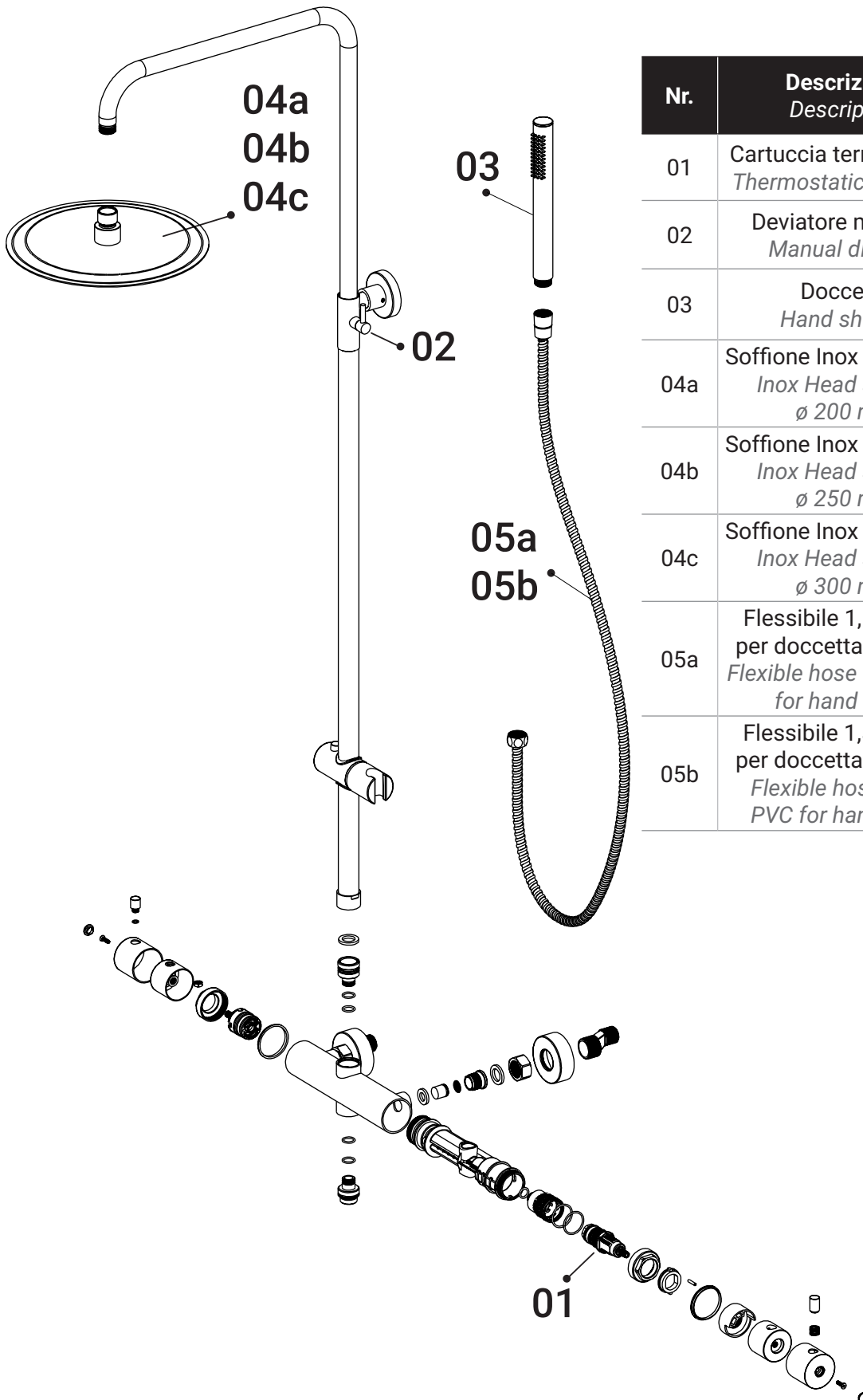

Nr.	Descrizione Description	Codice Code
01	Cartuccia termostatica Thermostatic cartridge	CA0017
02	Deviatore manuale Manual diverter	CA0016
03	Doccetta Hand shower	WSDTI
04a	Soffione Inox ø 200 mm Inox Head shower ø 200 mm	WSST20I
04b	Soffione Inox ø 250 mm Inox Head shower ø 250 mm	WSST25I
04c	Soffione Inox ø 300 mm Inox Head shower ø 300 mm	WSST30I
05a	Flessibile 1,5 m Inox per doccetta manuale Flexible hose 1,5 m Inox for hand spray	FL0004
05b	Flessibile 1,5 m PVC per doccetta manuale Flexible hose 1,5 m PVC for hand spray	FL0005



Prima dell'installazione Before Installation



Rimuovi tutto il contenuto dalla confezione e verificane la completezza.

Remove all contents from the package and check for completeness.

Strumenti necessari Tools you need

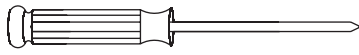

Cacciavite
Cross screwdriver

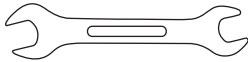

Chiave inglese
Wrench

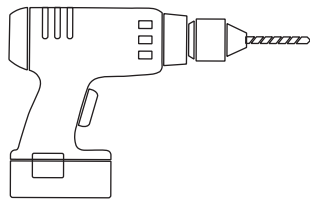

Trapano
Drill



Nastro di teflon
Teflon Tape

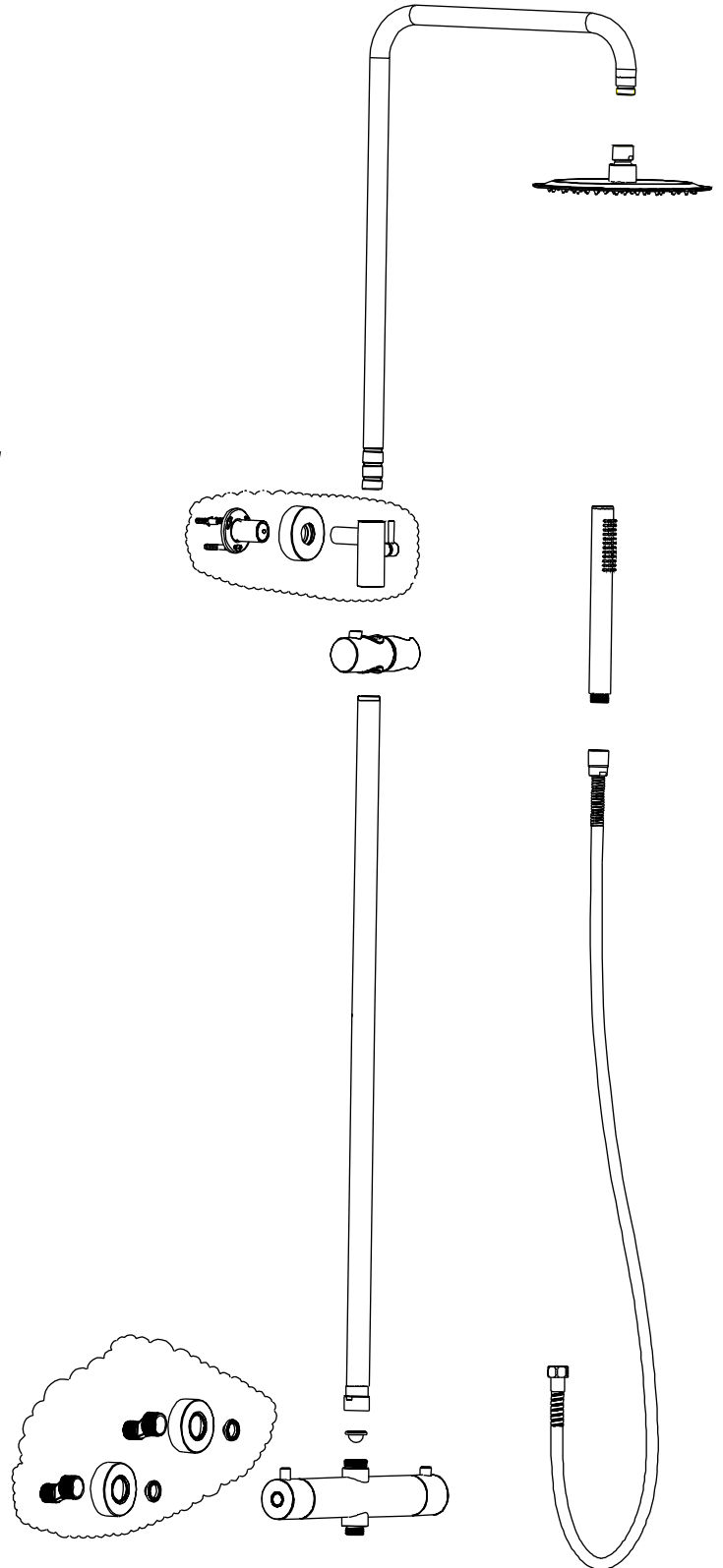



STEP 1

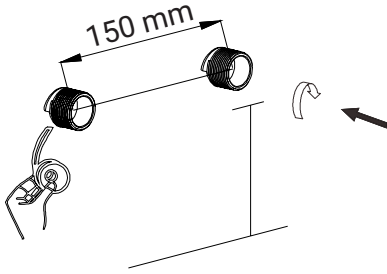

STEP 2

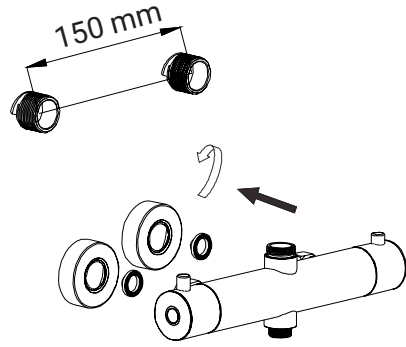

STEP 3

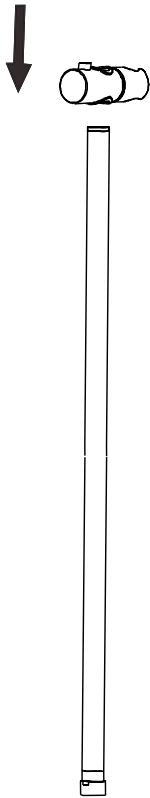

STEP 4

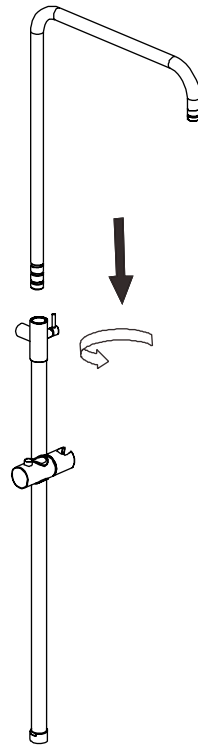

STEP 5

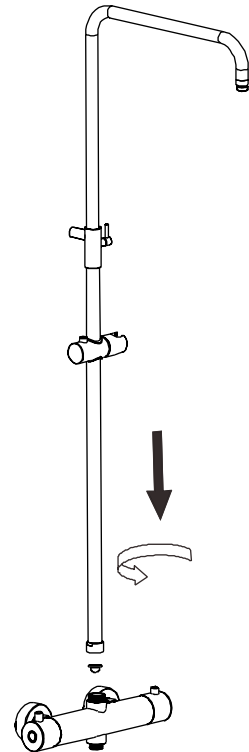



STEP 6

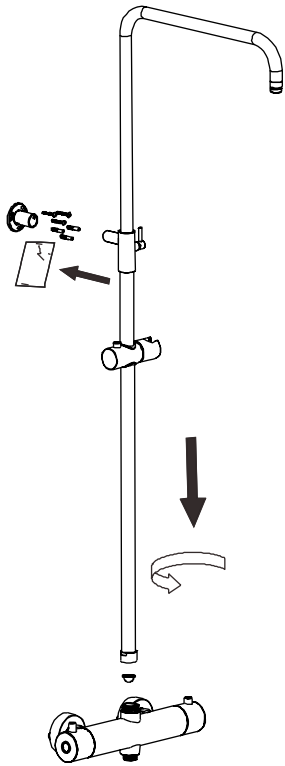

STEP 7

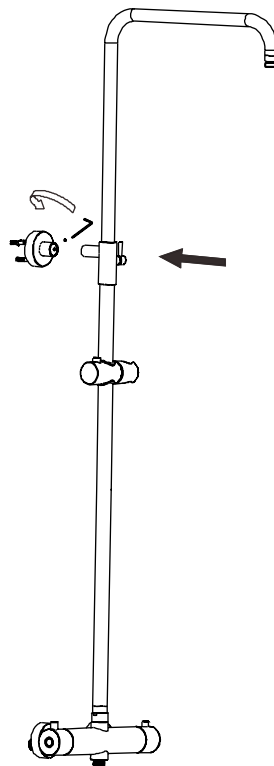

STEP 8

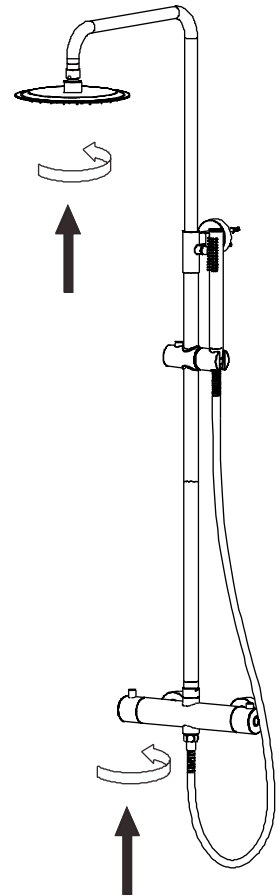



Misurazione (Measure)	Pressione (Pressure) (bar)	Portata Soffione (posizione 38° C) (Hot Head Shower Flow Rate) (l/min)
1	0	0,00
2	0,5	5,38
3	1	6,48
4	1,5	7,73
5	2	8,94
6	2,5	9,95
7	3	10,88
8	3,5	11,75
9	4	12,44
10	4,5	13,23
11	5	14,01
12	5,5	14,78
13	6	15,43

Massima Pressione Operativa (MPO): 5 bar

Maximum Operating Pressure (MOP): 5 bar

Test eseguito con connessioni originali

(Test performed with original connections)

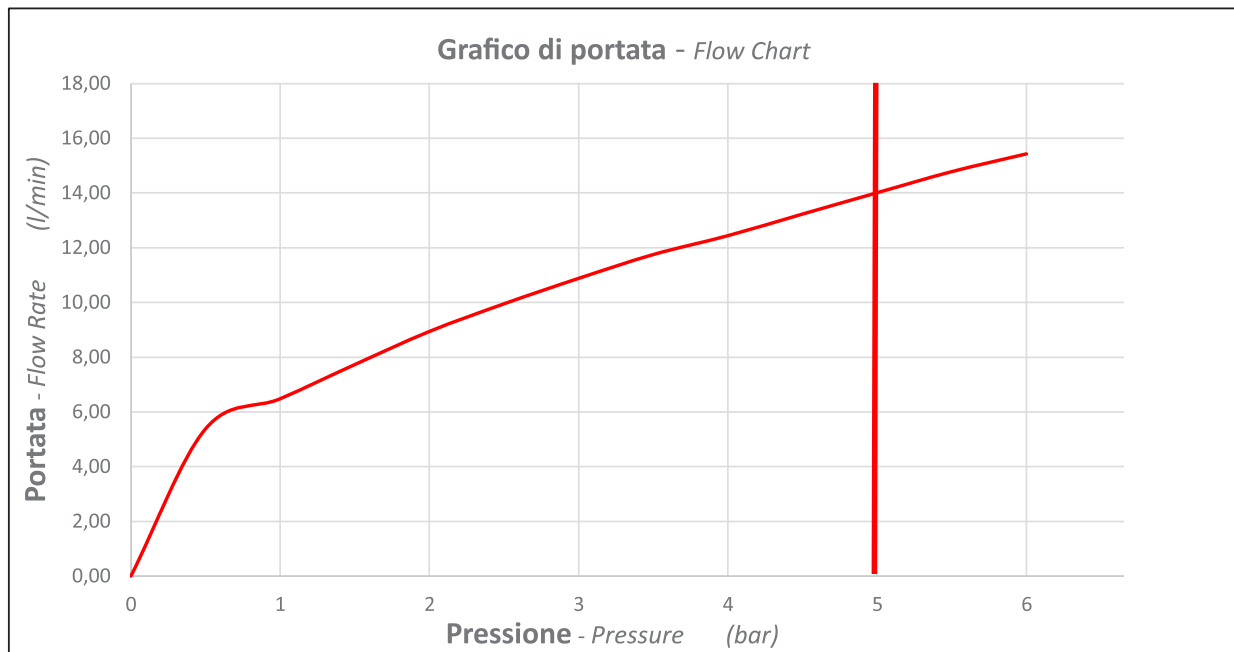

Non superare la pressione di 5 bar (linea rossa)

Do not exceed the pressure of 5 bar (red line)



Misurazione (Measure)	Pressione (Pressure) (bar)	Portata Doccetta (posizione 38° C) (Hot Hand Shower Flow Rate) (l/min)
1	0	0,00
2	0,5	4,60
3	1	5,44
4	1,5	6,62
5	2	7,73
6	2,5	8,62
7	3	9,49
8	3,5	10,24
9	4	11,05
10	4,5	11,92
11	5	12,36
12	5,5	13,12
13	6	13,54

Massima Pressione Operativa (MPO): 5 bar

Maximum Operating Pressure (MOP): 5 bar

Test eseguito con connessioni originali

(Test performed with original connections)

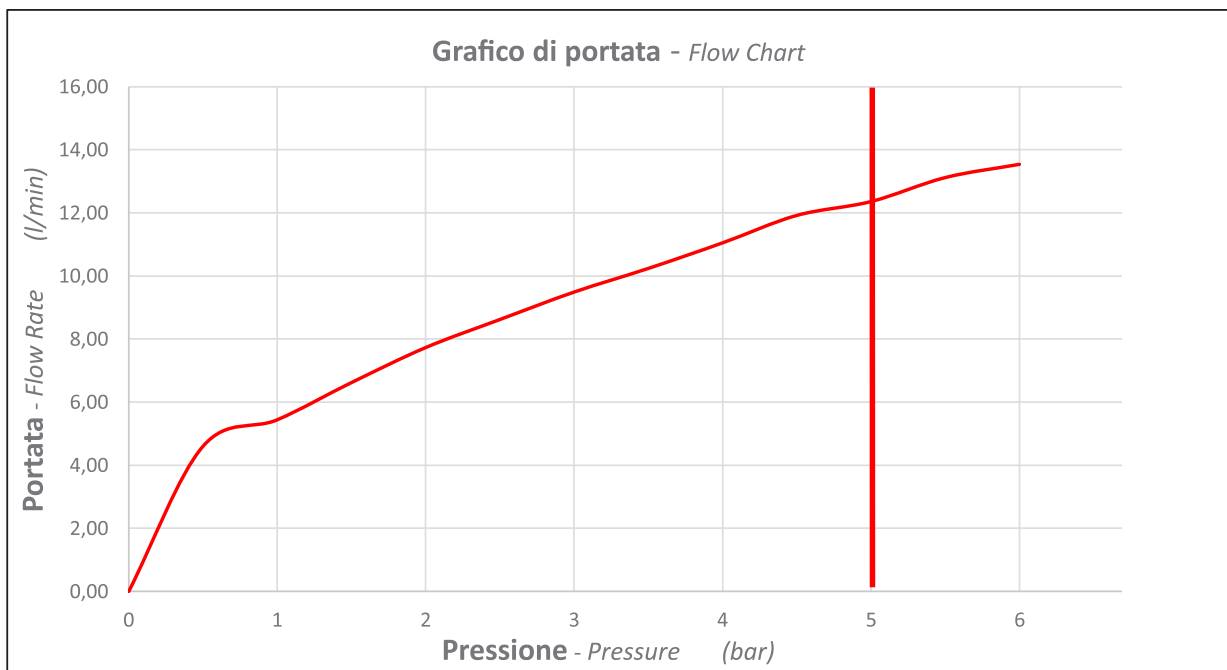

Non superare la pressione di 5 bar (linea rossa)

Do not exceed the pressure of 5 bar (red line)



Non utilizzare, per la pulizia, in nessun caso acidi, solventi, candeggina, ammoniaca o prodotti contenenti acidi e spugne o spazzole con effetto abrasivo.

Never use acids, solvents, bleach, ammonia or products containing acids and sponges or brushes with an abrasive effect for cleaning.



Per un corretto mantenimento dei prodotti si consiglia una pulizia periodica attraverso detergenti neutri o acqua e sapone.

For correct maintenance of the products, periodic cleaning is recommended using neutral detergents or soap and water.



Per evitare la formazione di depositi calcarei sciacquare sempre le superfici dopo lavaggio con abbondante acqua e asciugare accuratamente con un panno morbido.

To avoid the formation of limescale deposits, always rinse the surfaces after washing with plenty of water and dry carefully with a soft cloth.