



**Manuale d'installazione**  
*Installation Manual*

**WELLNESS**  
**SERIES**  
**Inox**



**Colonna doccia esterna  
da parete completa**  
**(Doccetta tonda, Soffione tondo)**  
*Exposed shower group*  
*(round Head Shower, round Hand Shower)*

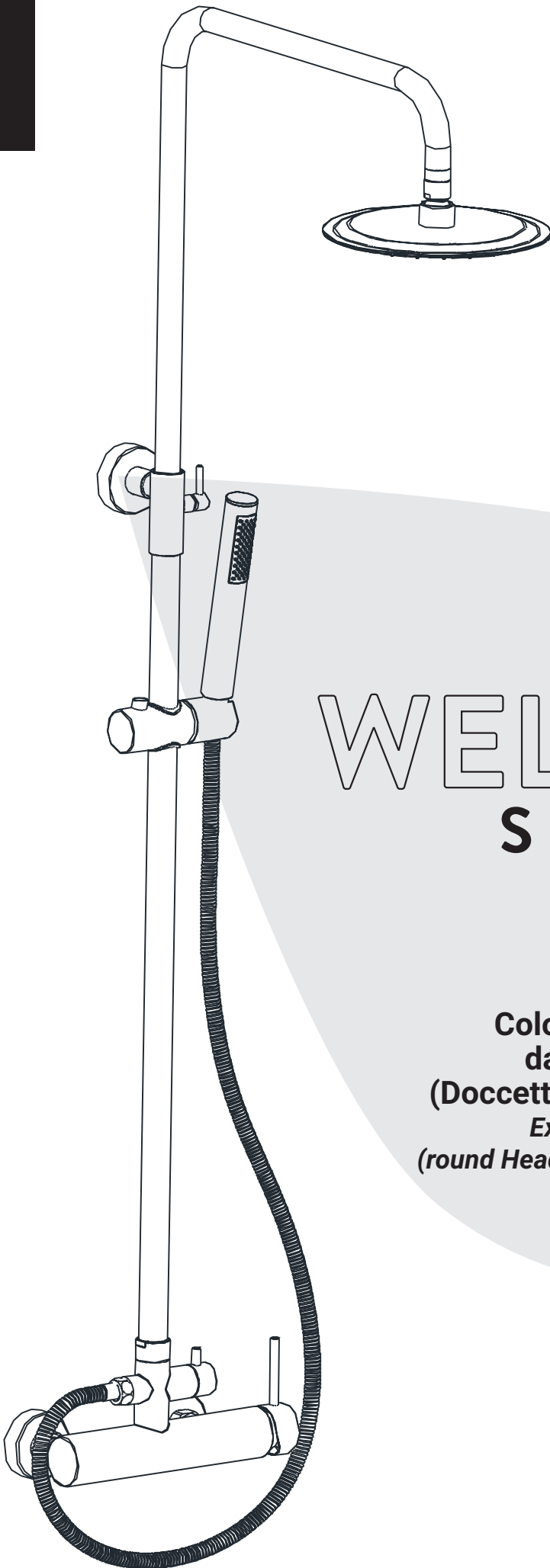



## Indice

### Index

Dimensioni <i>Dimensions</i> .....	pag. 3
Ricambi <i>Spare parts</i> .....	pag. 4
Installazione <i>Installation</i> .....	pag. 5/7
Portate <i>Flows</i> .....	pag. 8/9
Manutenzione Generale <i>General Maintenance</i> .....	pag. 10

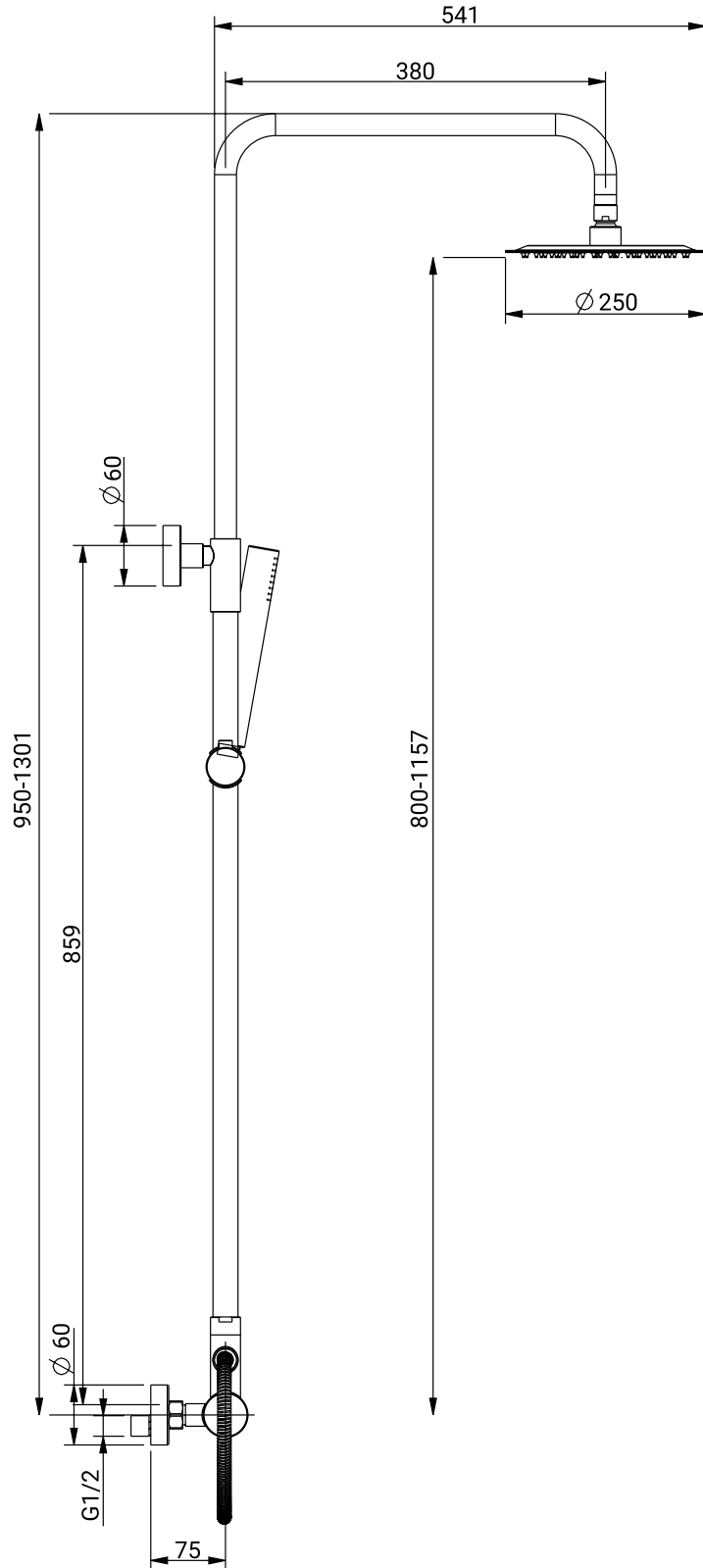

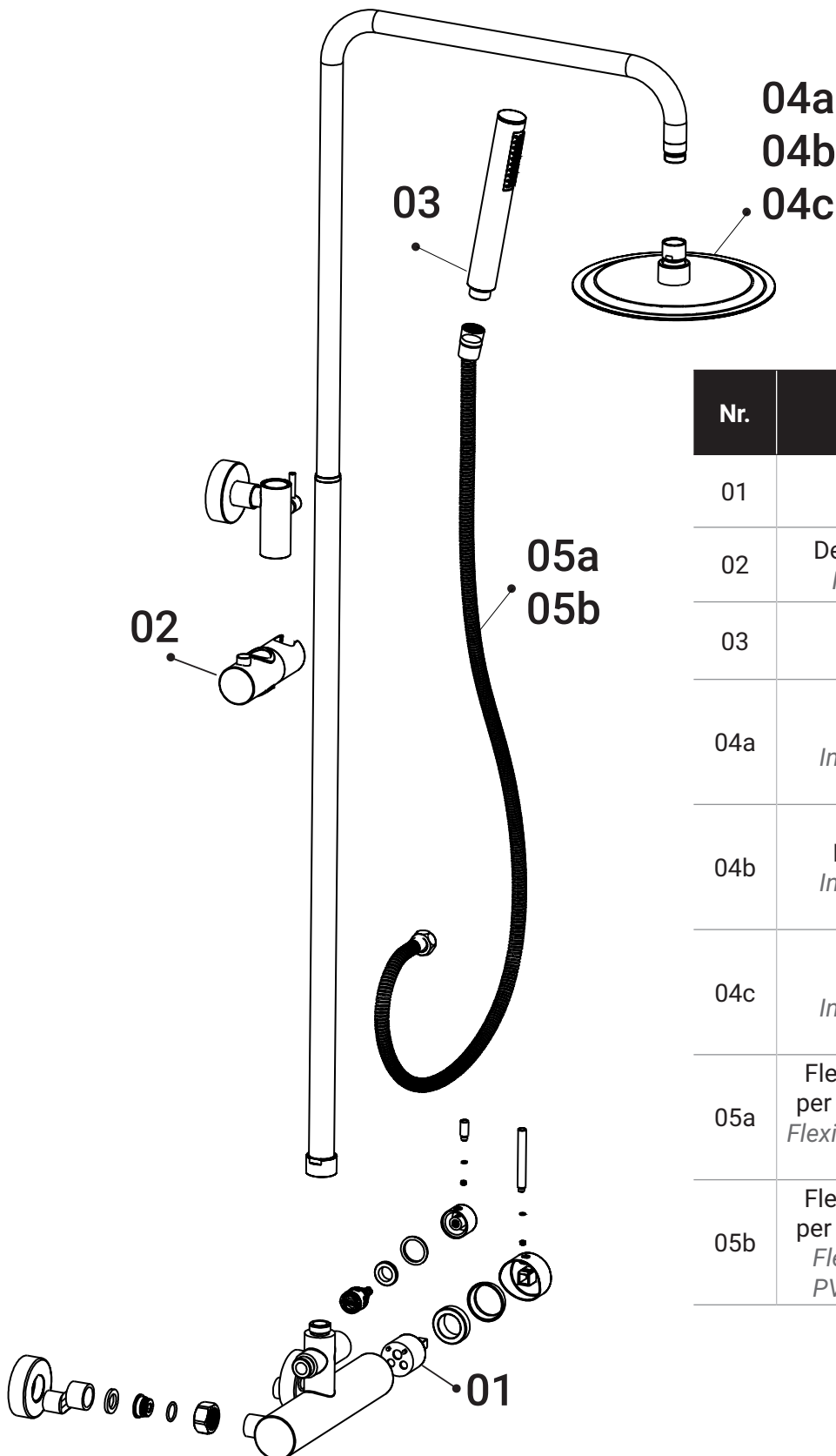

Nr.	Descrizione Description	Codice Code
01	Cartuccia Cartridge	CA0013
02	Deviatore manuale Manual diverter	CA0014
03	Doccetta Hand shower	WSDTI
04a	Soffione Inox Ø 200 mm Inox Head shower Ø 200 mm	WSST20I
04b	Soffione Inox Ø 250 mm Inox Head shower Ø 250 mm	WSST25I
04c	Soffione Inox Ø 300 mm Inox Head shower Ø 300 mm	WSST30I
05a	Flessibile 1,5 m Inox per doccetta manuale Flexible hose 1,5 m Inox for hand spray	FL0004
05b	Flessibile 1,5 m PVC per doccetta manuale Flexible hose 1,5 m PVC for hand spray	FL0005

**Prima dell'installazione**  
*Before Installation*

Rimuovi tutto il contenuto dalla confezione e verificane la completezza.

*Remove all contents from the package and check for completeness.*

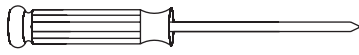
**Strumenti necessari**  
*Tools you need*

Cacciavite  
*Cross screwdriver*

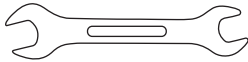

Chiave inglese  
*Wrench*

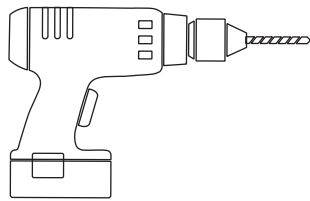

Trapano  
*Drill*



Nastro di teflon  
*Teflon Tape*

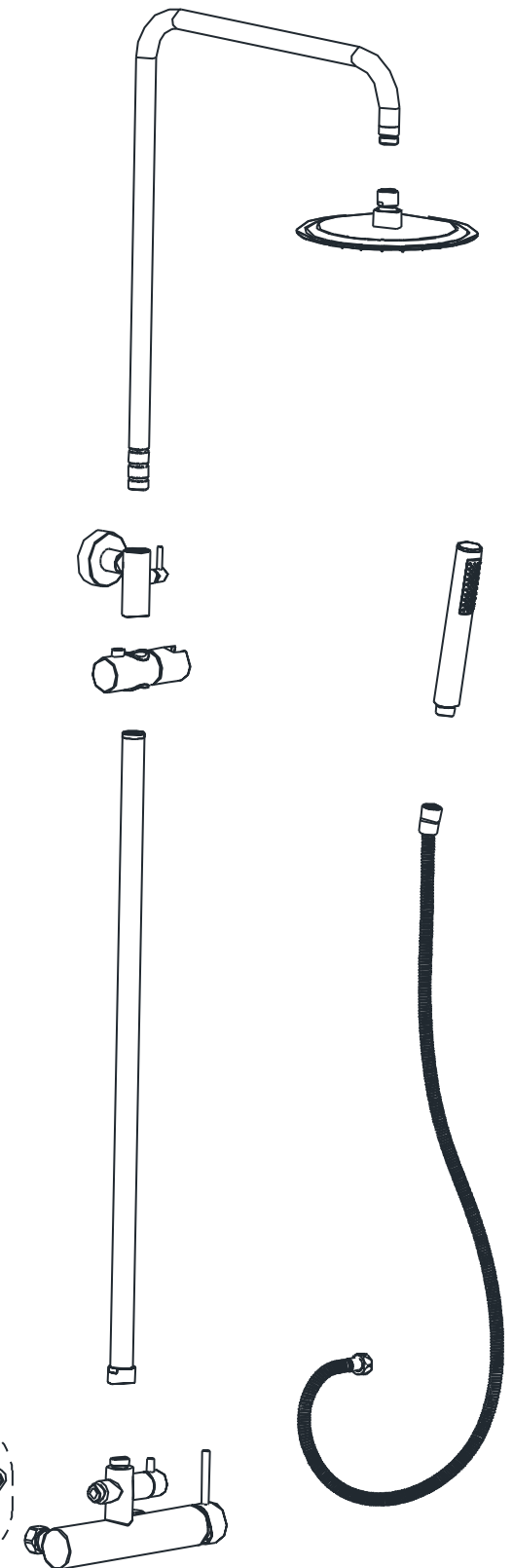



STEP 1

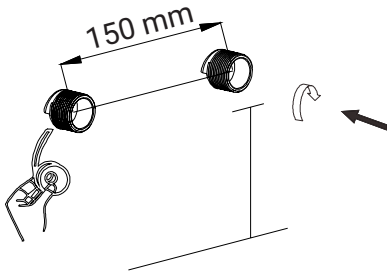

STEP 2

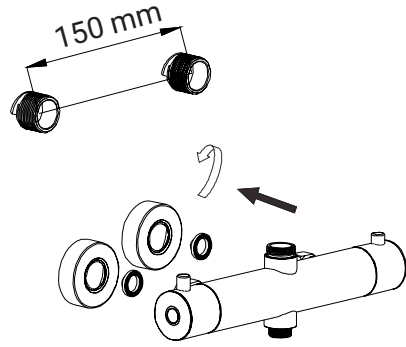

STEP 3

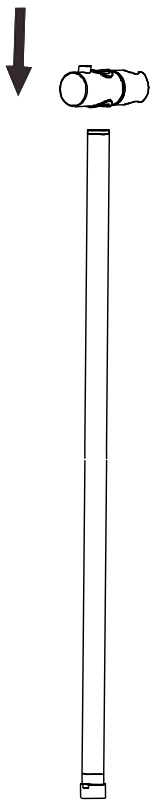

STEP 4

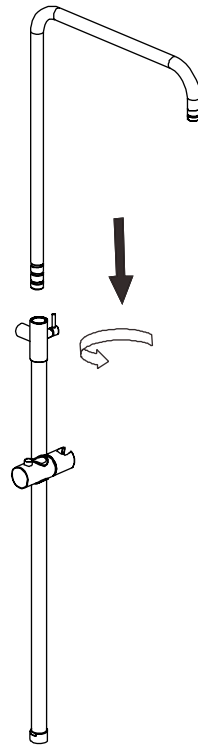

STEP 5

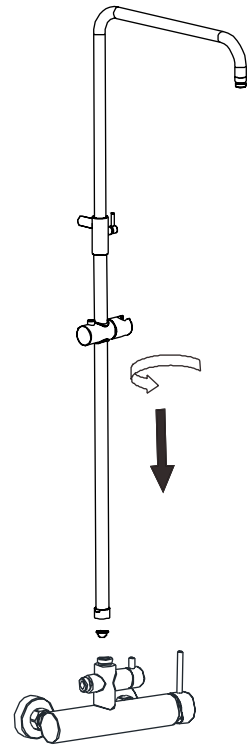



### STEP 6

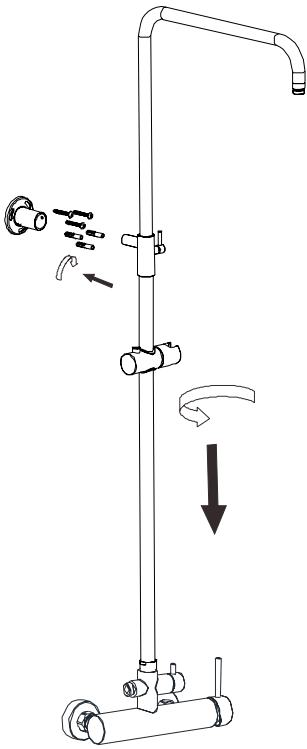

### STEP 7

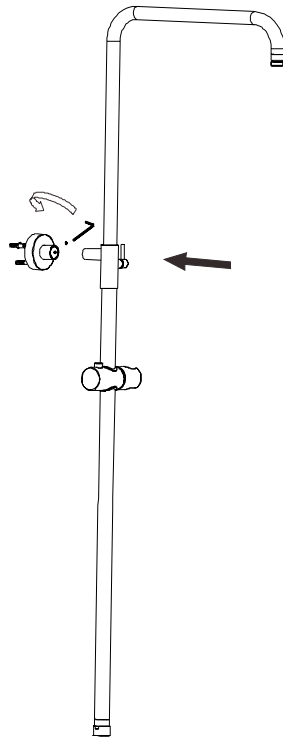

### STEP 8

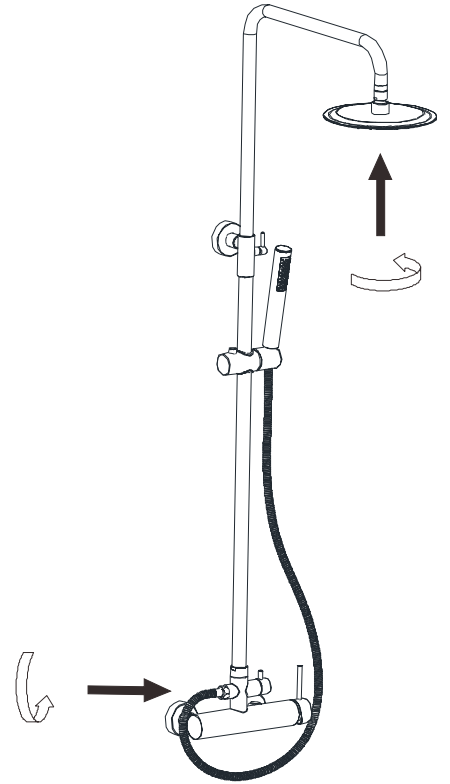

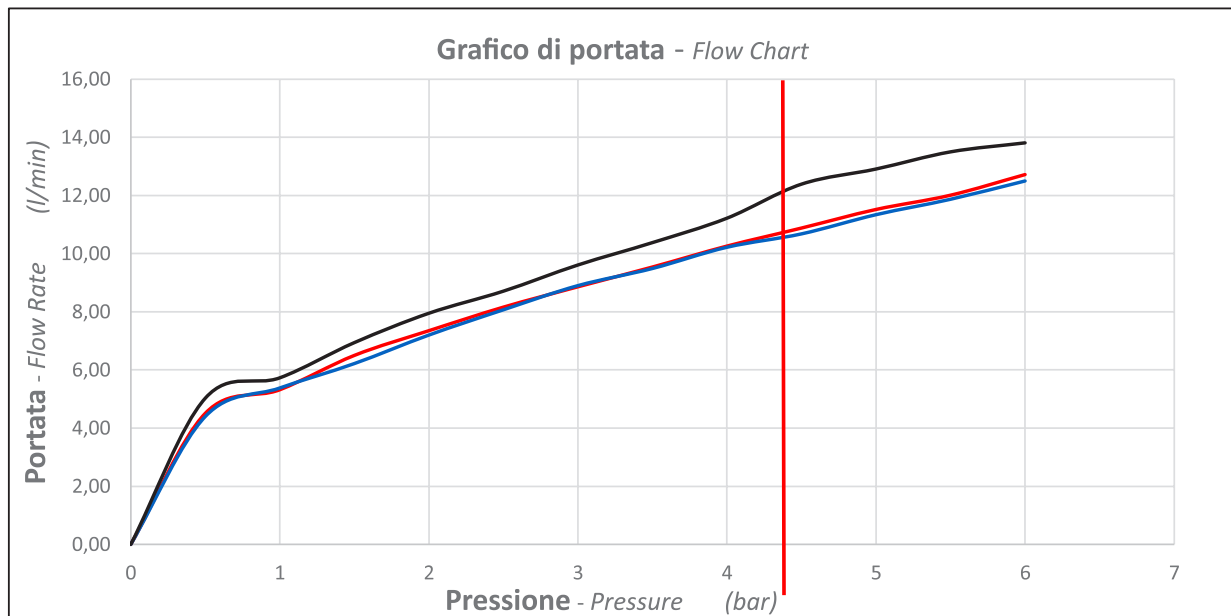

Misurazione (Measure)	Pressione (Pressure) (bar)	Portata Calda SOFFIONE (Hot Flow Rate) (l/min)	Portata Fredda SOFFIONE (Cold Flow Rate) (l/min)	Portata Miscelata SOFFIONE (Mix Flow Rate) (l/min)
1	0	0,00	0,00	0,00
2	0,5	4,51	4,40	5,03
3	1	5,32	5,38	5,73
4	1,5	6,50	6,22	6,94
5	2	7,35	7,20	7,95
6	2,5	8,16	8,07	8,71
7	3	8,86	8,90	9,61
8	3,5	9,54	9,49	10,38
9	4	10,26	10,22	11,22
10	4,5	10,88	10,68	12,39
11	5	11,52	11,34	12,91
12	5,5	12,01	11,87	13,50
13	6	12,72	12,50	13,81

**Massima Pressione Operativa (MPO): 5 bar***Maximum Operating Pressure (MOP): 5 bar***Test eseguito con flessibili originali***(Test performed with original Hoses)***Non superare la pressione di 5 bar (linea rossa)***Do not exceed the pressure of 5 bar (red line)*



Misurazione (Measure)	Pressione (Pressure) (bar)	Portata Calda DOCCETTA (Hot handshower Flow Rate) (l/min)	Portata Fredda DOCCETTA (Cold handshower Flow Rate) (l/min)	Portata Miscelata DOCCETTA (Mix handshower Flow Rate) (l/min)
1	0	0,00	0,00	0,00
2	0,5	4,16	4,02	4,40
3	1	4,92	4,83	5,15
4	1,5	6,02	5,87	6,39
5	2	6,86	6,77	7,41
6	2,5	7,64	7,55	8,22
7	3	8,38	8,22	8,94
8	3,5	9,26	9,06	9,78
9	4	9,78	9,75	10,45
10	4,5	10,45	10,26	11,05
11	5	11,03	10,71	11,66
12	5,5	11,72	11,32	12,42
13	6	12,16	11,98	12,91

**Massima Pressione Operativa (MPO): 5 bar**

*Maximum Operating Pressure (MOP): 5 bar*

**Test eseguito con flessibili originali**

*(Test performed with original Hoses)*

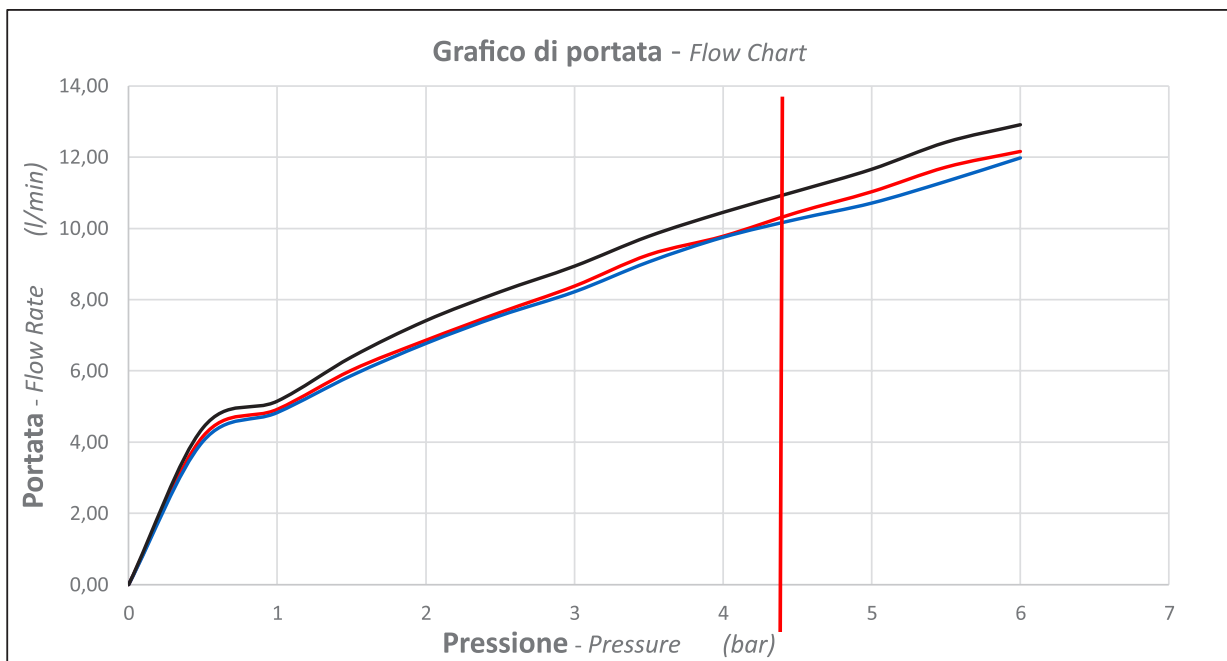

**Non superare la pressione di 5 bar (linea rossa)**

*Do not exceed the pressure of 5 bar (red line)*



Non utilizzare, per la pulizia, in nessun caso acidi, solventi, candeggina, ammoniaca o prodotti contenenti acidi e spugne o spazzole con effetto abrasivo.

*Never use acids, solvents, bleach, ammonia or products containing acids and sponges or brushes with an abrasive effect for cleaning.*

---



Per un corretto mantenimento dei prodotti si consiglia una pulizia periodica attraverso detergenti neutri o acqua e sapone.

*For correct maintenance of the products, periodic cleaning is recommended using neutral detergents or soap and water.*

---



Per evitare la formazione di depositi calcarei sciacquare sempre le superfici dopo lavaggio con abbondante acqua e asciugare accuratamente con un panno morbido.

*To avoid the formation of limescale deposits, always rinse the surfaces after washing with plenty of water and dry carefully with a soft cloth.*